



Bushey Hall Winchmaster

Thirty years' experience with electric winches has provided the BHW Group with the technical expertise necessary to provide cost effective winch solutions to a wide diversity of industries.

Close co-operation with vehicle conversion companies has enabled BHW to produce a series of safe, reliable and smooth running mobility systems that are an important aid to help ensure compliance with the EU manual handling regulations. Our systems are TUV approved.

This unobtrusive system is neatly concealed underneath the front seats with only the access tube and chair attachment straps visible.

Carers are able to wheel the chair and occupant up and down the inclined ramp in safety and without effort.

WINCH•ASSIST Concealed Winch System for Wheelchair Access Vehicles



FIAT DOBLO - LOW FLOOR
MOB0385 / 6163



FIAT DOBLO - HIGH ROOF
MOB0386 / 6164



RENAULT KANGOO
MOB0380 / 6162



CITROEN BERLINGO
MOB0385 / 6163



WINCH•ASSIST is a unique concealed unit mounted underneath the passenger seat, with a central guide for the winch rope and straps, ensuring a smooth, balanced operation.

The BHW Group are constantly updating the list of vehicles for WINCH•ASSIST.

Please call sales for the latest updates, or for parts enquiries.



FIAT SCUDO
MOB0398 / 6173



FORD CONNECT TOURNEO
MOB0388 / 6166



PEUGEOT EXPERT
MOB0398 / 6173



VW CADDY
MOB0390 / 6168



UNDER SEAT WINCH KIT PARTS Please ensure that you quote the correct code numbers for the right vehicle:

DC WINCH

- Safe working load 800N
- Line speed mean average 7.5m/m
- Amperage draw 25 amps
- No motor brake.
- All gears running in oil.

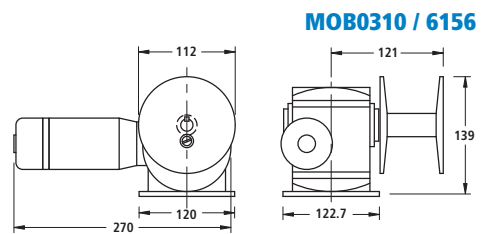

MOB0310 / 6156

UNDER SEAT MOUNTING BRACKET & ROPE GUIDE



Mounting brackets and rope guides are normally only sold as part of a complete kit for specific vehicles.

Should you need replacements for any reason, please contact our sales team, who will be happy to help.

ELECTRICAL RELAY PACK

12v relay box with thermal cut out switch.
System includes motor filter for EU compliance with the EMC Directive.

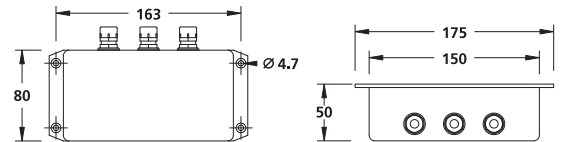

MOB1601 / 6198

WANDERLEAD

WL0015 / 7731



Wanderlead control with flexible cable and jack socket.

WEB STRAPS & ROPE

ST0651 / 7356



CONTROL PANEL

MOB1015 / 6188



Includes:
Emergency Stop, On/Off and Reset buttons.
Jack socket to accept wanderlead control.

AUTOMATIC SAFETY CUT OFF SWITCH

MOB1044 / 6195



NON-STANDARD OPTION

The soft rubber buffer fitted onto the rope activates unique safety pressure STOP switch integral with the exit tube-securing bracket.
The soft rubber buffer also prevents the possibility of trapped fingers or hands whilst retrieving the winch rope.

The BHW Group are constantly updating the list of vehicles for WINCH•ASSIST.

Please call sales for the latest updates, or for parts enquiries.